

SAMSUNG



Samsung Knox Frontline in a Nutshell

May 2021 – v1.0
Samsung Electronics



Knox Frontline Products

SAMSUNG



KME Direct

Easy Configuration and Staging tools for on premise environment for B2B devices and peripherals



Knox Capture

The application for frontline workers which enables data capture, data formatting and data wedge without B2B app modification



Knox Asset Intelligence

Data analytics solution that offers operational visibility and actionable insights



Knox SDK for ISV (included in Knox SDK)

SDK and APIS for ISV partners who want granular control and configuration for B2B devices and peripherals

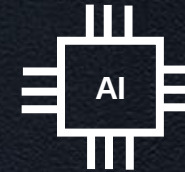

Knox ML Encryption Tool

APIs and tools in order to execute partner's machine learning model on mobile devices

Knox Mobile Enrollment Direct

Easy Configuration and Staging tool for on-premise / closed network environment

Simple provisioning

No pre-steps for staging & kitting, just out of the box scanning of the QR code

Time saving

Automated staging flow from network connection to device configuration

Peripheral Settings Configuration

Plug & auto configuration for peripheral devices

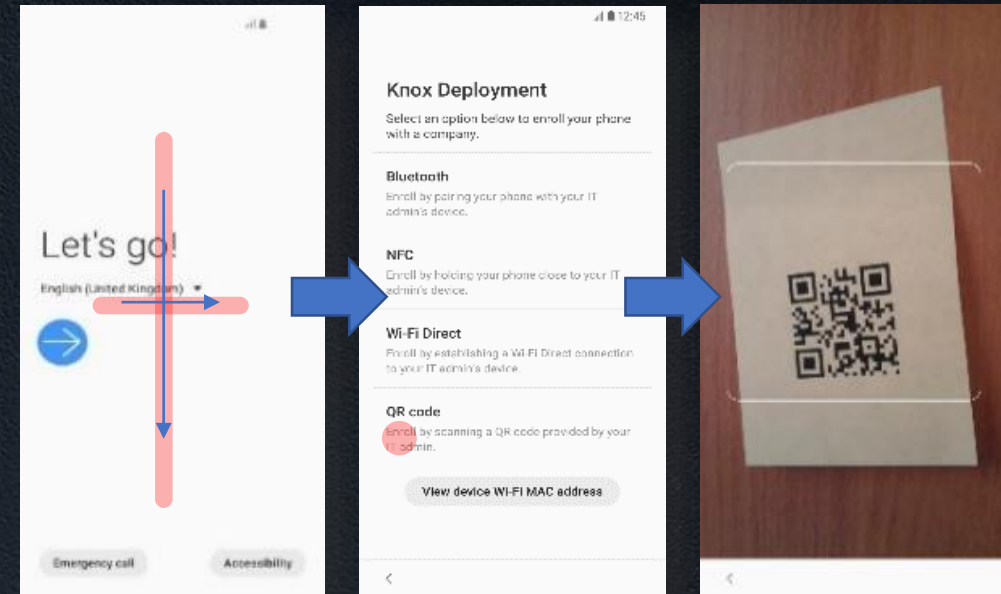

Knox Capture

The easiest way to turn your mobile phone into a barcode scanner

Smartphone and Scanner in one – with enhanced performance

Zero code modification with full manageability

Configure effortlessly and deploy in bulk over-the-air

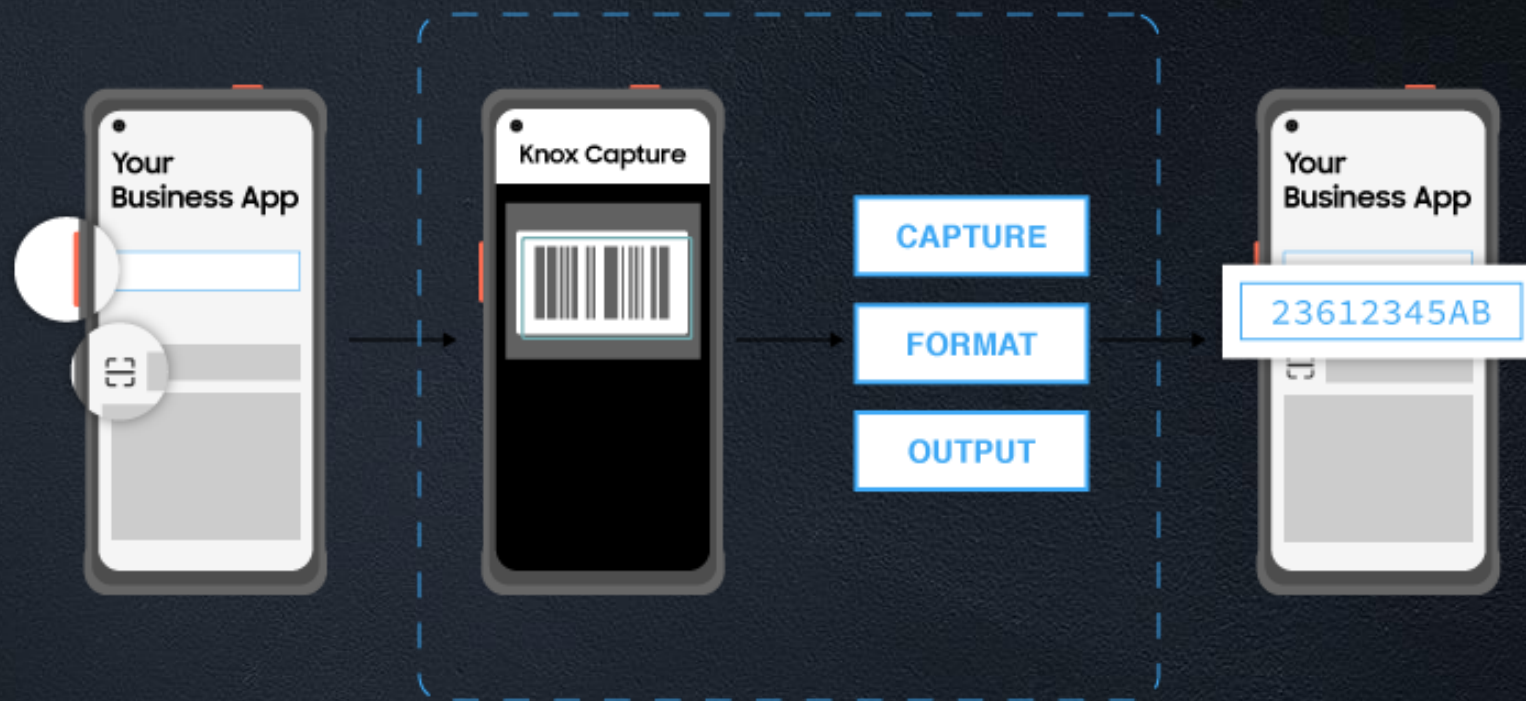

Knox Asset Intelligence

Cloud-based data analytics solution that offers operational visibility and actionable insights for improving the management, productivity and lifecycle of your business devices



Knox ML (Machine Learning) Encryption Tool

PC tool enables encryption of an Enterprise's ML model and secure execution on Samsung devices' Knox platform

Easy to use

One-click for encryption of the plain (non-encrypted) ML model

** Compatible with Windows, Linux OS*

Set a policy

Set package version to maintain ML's history and allowed apps list that is accessible to the encrypted ML model

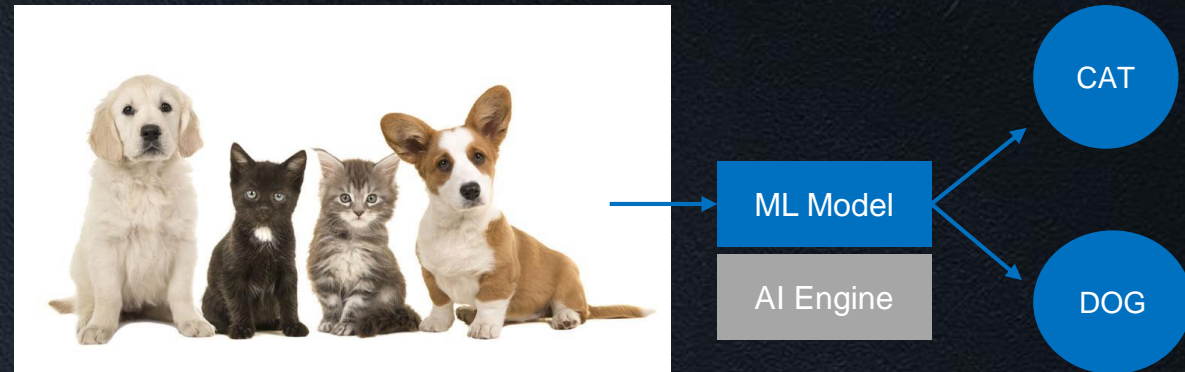

Knox SDK for ISVs

Single SDK to configure devices and peripherals for Frontline work environment

H/W key remapping

Capability to allows an app to modify the behavior of one or more hardware keys when such keys are pressed and released.

Touch sensitivity

Adjust touch-screen sensitivity for different user scenarios on devices. Touch sensitivity setting can be changed when working with gloves to increase touch accuracy.

Keyboard setting

Control device keyboard settings. B2B apps can change default keyboard each for personal space and workspace.

Power Configuration

Set Power saving mode to save battery life.

Device Configuration

Set device settings. (Date and time, display timeout, etc.)

Peripheral Configuration (Koamtac Sled supported)

Set Barcode Profile, Beep Sounds, etc.

Visit **SamsungKnox.com** to :

1

Learn
more

2

Try
for free

3

Contact
sales